

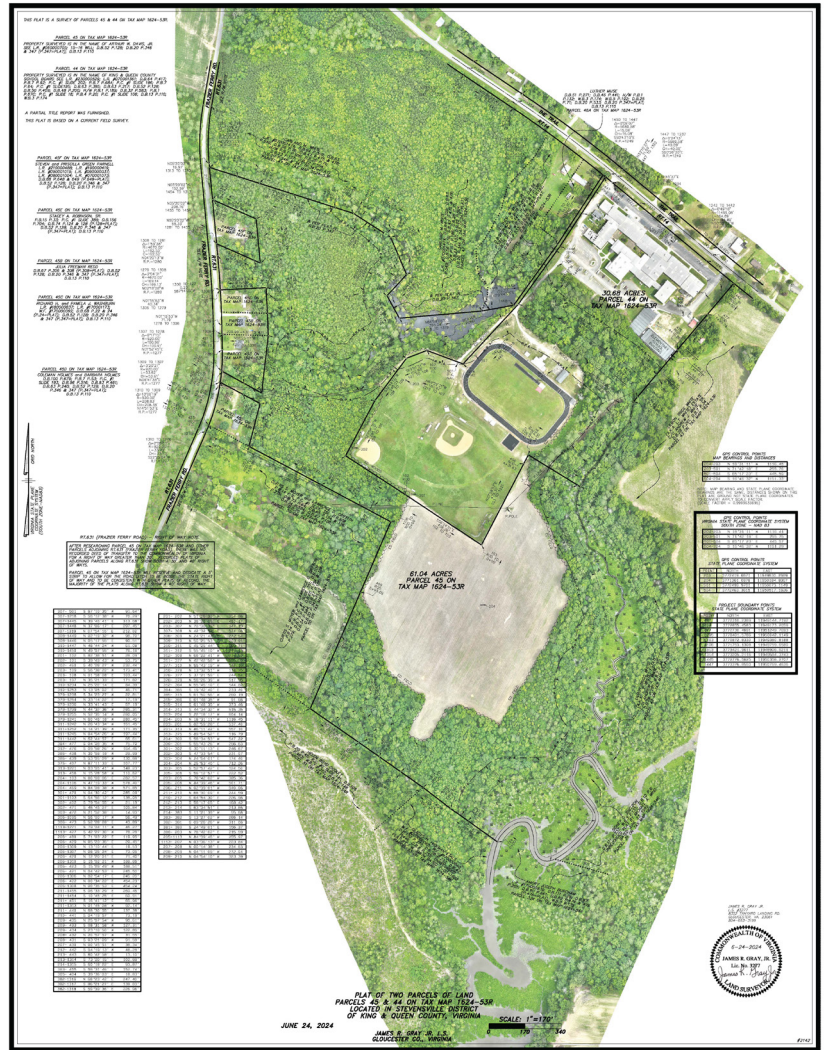

# BUILDING FOR THE FUTURE: A NEW ERA FOR KING AND QUEEN COUNTY SCHOOLS



A new academic  
campus is coming  
to King and Queen.



## Project Timeline

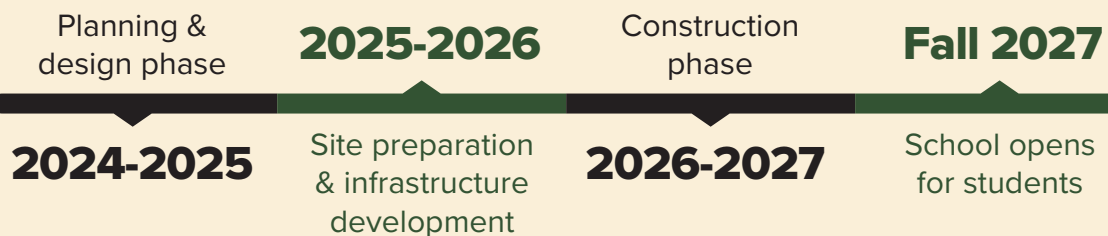

Here's  
what you  
need to  
know!

## Why a new academic campus?

The current King and Queen Elementary School is no longer suitable due to structural deficiencies, outdated infrastructure, and limited capacity for modern education.

A temporary facility is in use, but a long-term solution is necessary to provide a safe, high-quality learning environment.

### Key Benefits

- **Modern Learning Spaces:** Interactive classrooms with cutting-edge technology to boost engagement.
- **STEM & Digital Literacy:** Hands-on programs in science, tech, engineering, and math to prepare students for tomorrow.
- **Safety & Accessibility:** Secure entrances, emergency systems, and ADA-compliant design.
- **Sustainability:** Energy-efficient materials lower costs and environmental impact.

### Location & Infrastructure Upgrades

- New school built on 61 acres next to the high school, creating a 91-acre education hub.
- Upgraded roads, utilities, and high-speed internet to support digital learning.
- Transportation study to improve bus routes.
- Designed by Grimm + Parker Architects, experts in educational facilities.

### Community Engagement

- Public meetings and surveys ensure community input.
- Project updates shared via the county website, social media, and Board meetings.
- Transparent planning with open forums and budget disclosures..



### Stay Informed!

For more information and updates, visit [kingandqueenco.net](http://kingandqueenco.net) or attend upcoming public meetings.

*Investing in our  
schools means investing  
in our community's future!*

A stylized yellow sun with a circular center and several short, radiating lines representing sunbeams.